

SEZIONE IN ASSE SPALLA 'SP2'

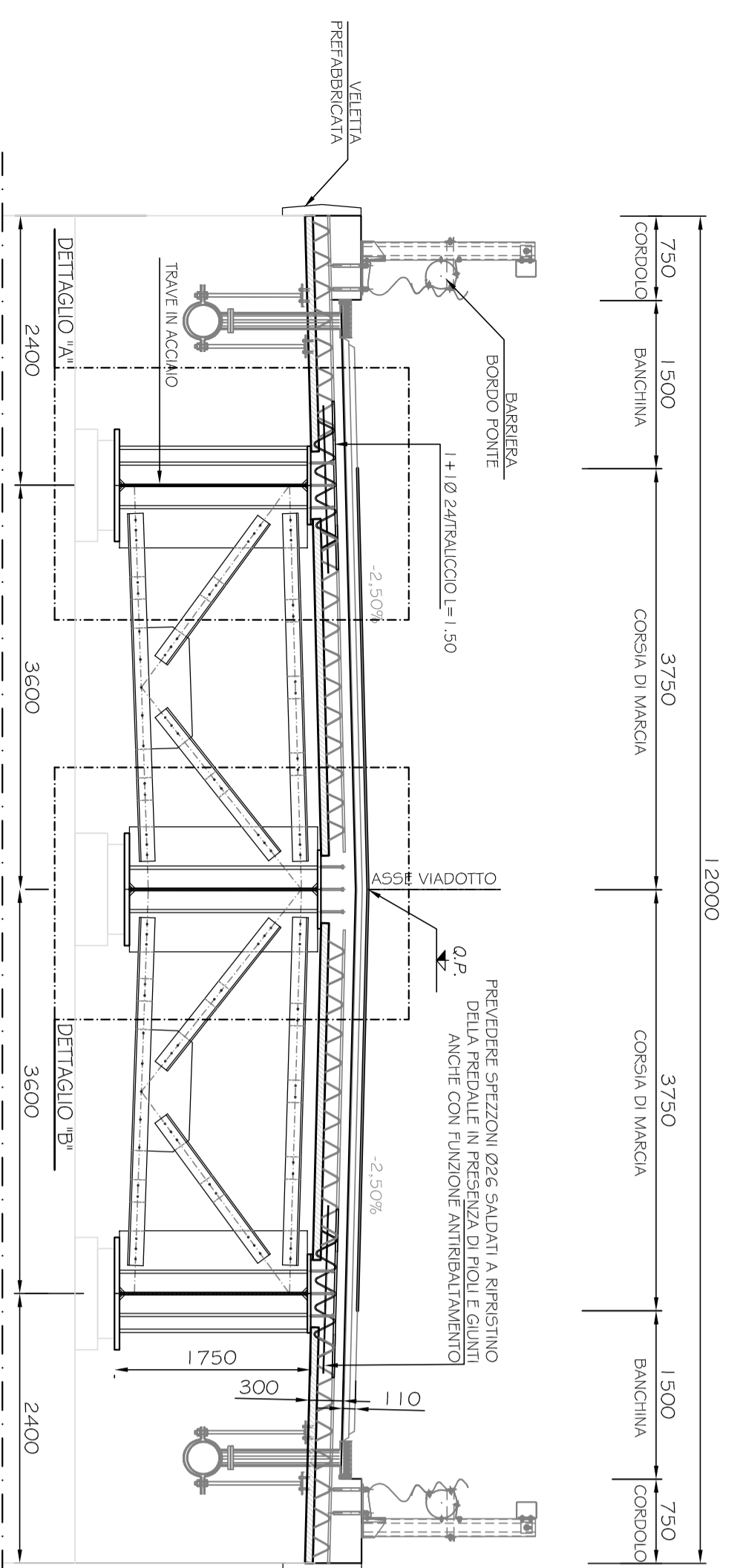

DETTAGLIO 'A'

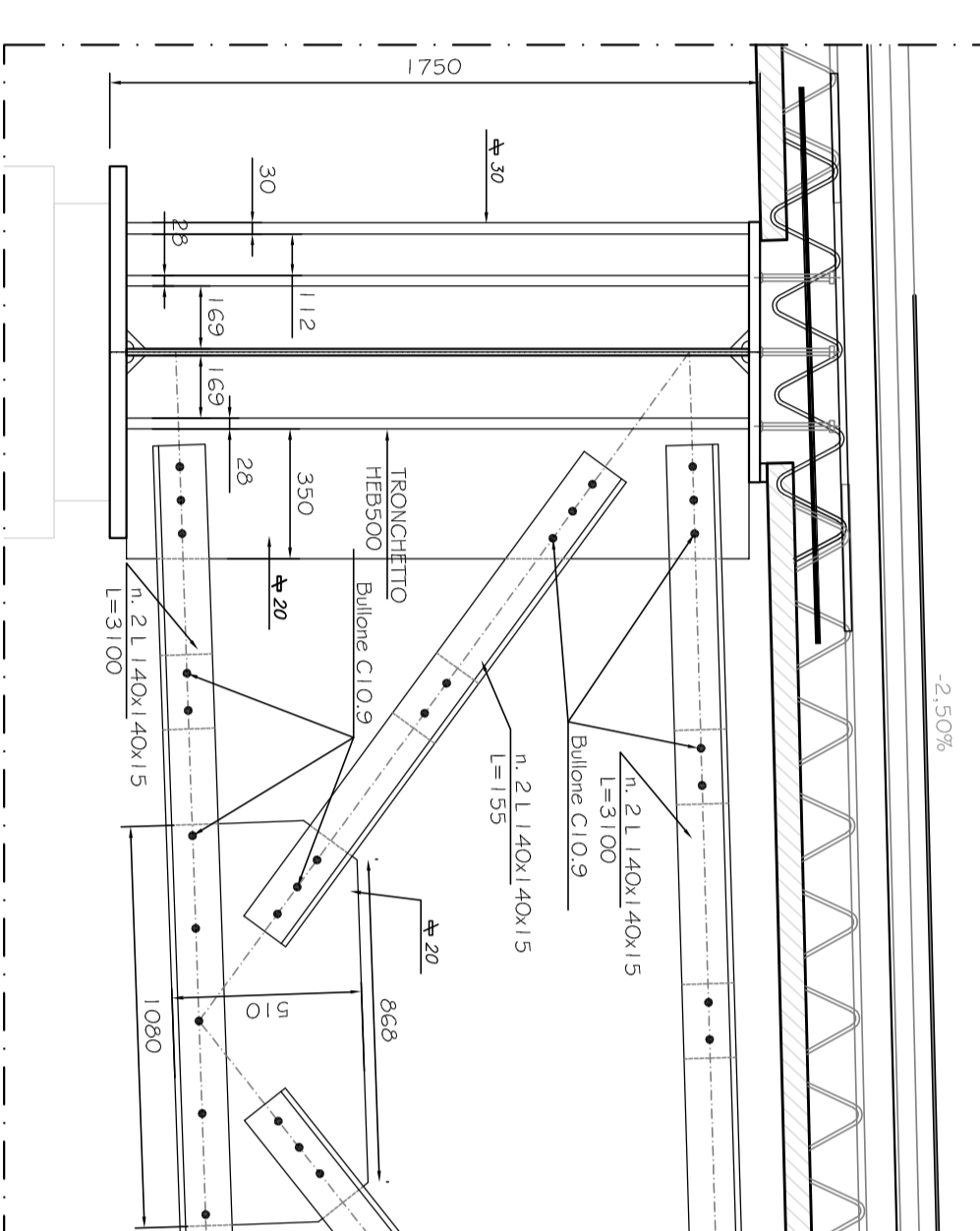

DETTAGLIO 'B'

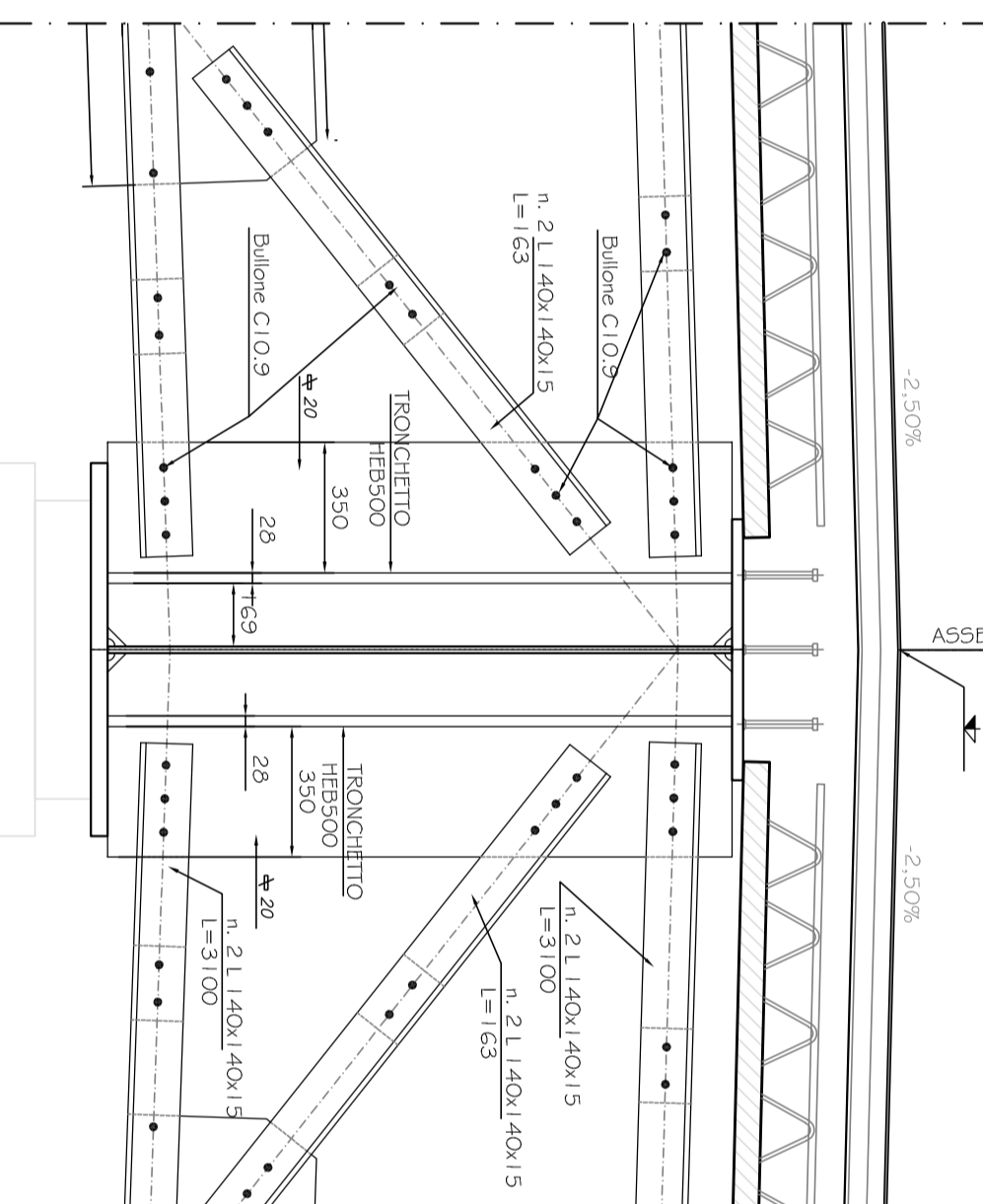

RINFORZO ALL'APPOGGIO

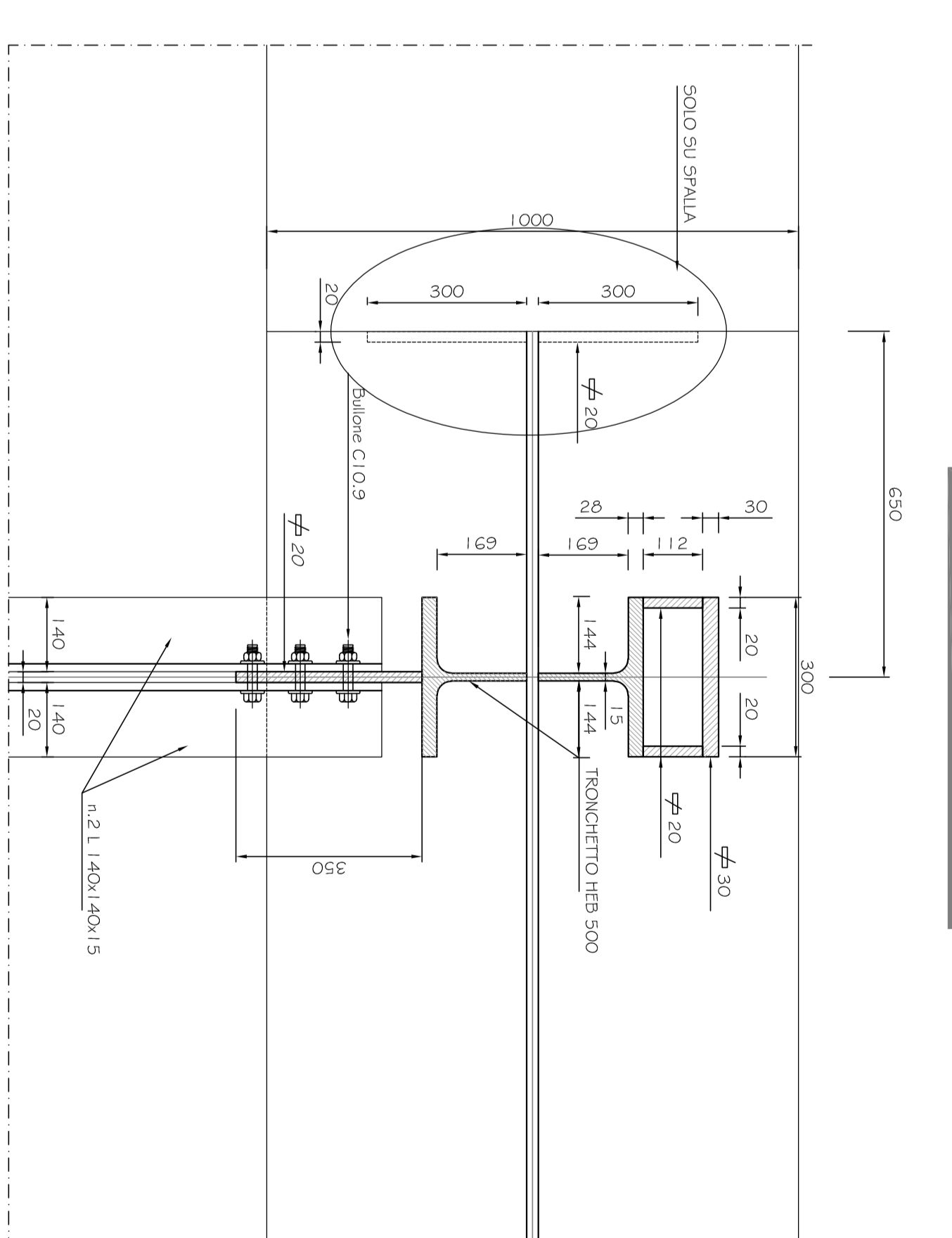

SEZIONE CORRENTE TRAVE H=1,75m

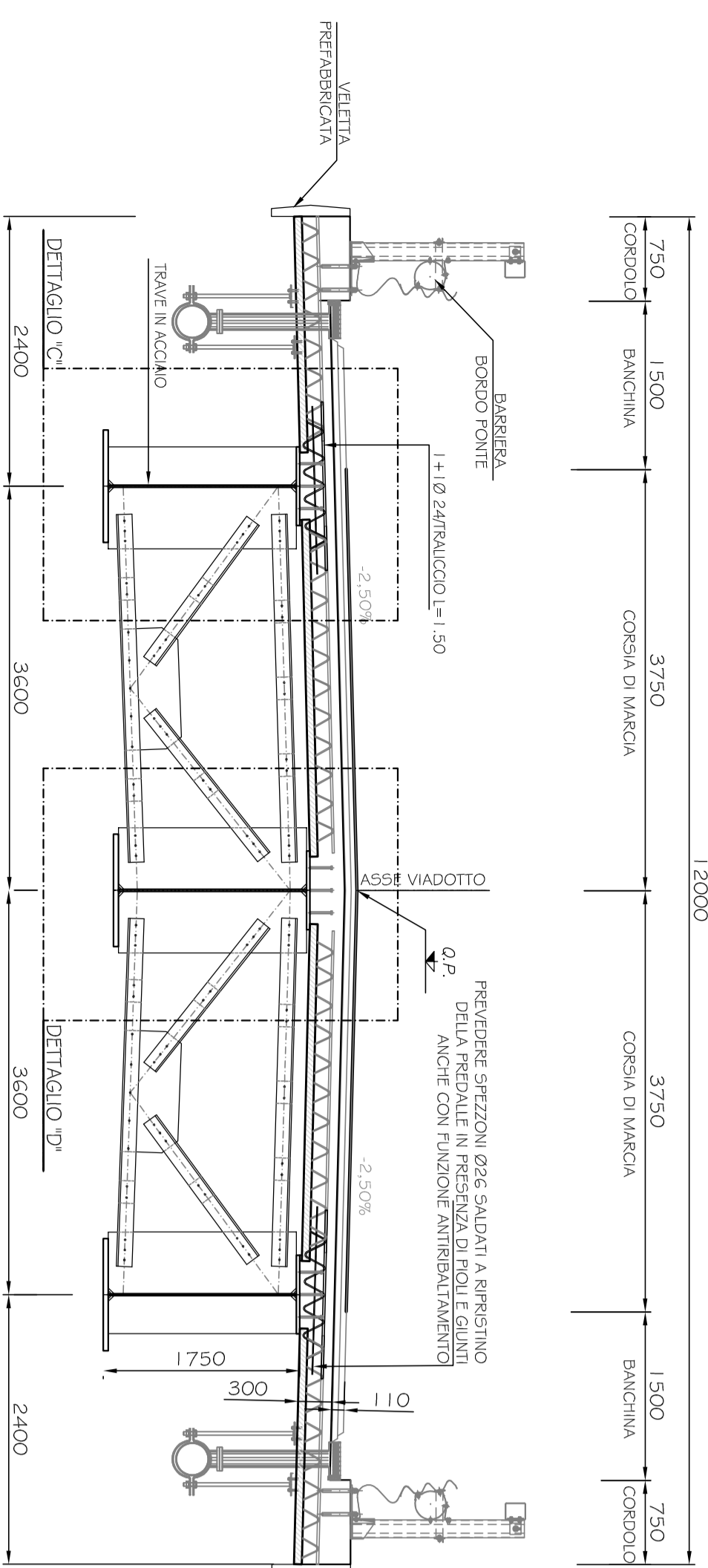

DETTAGLIO 'C'

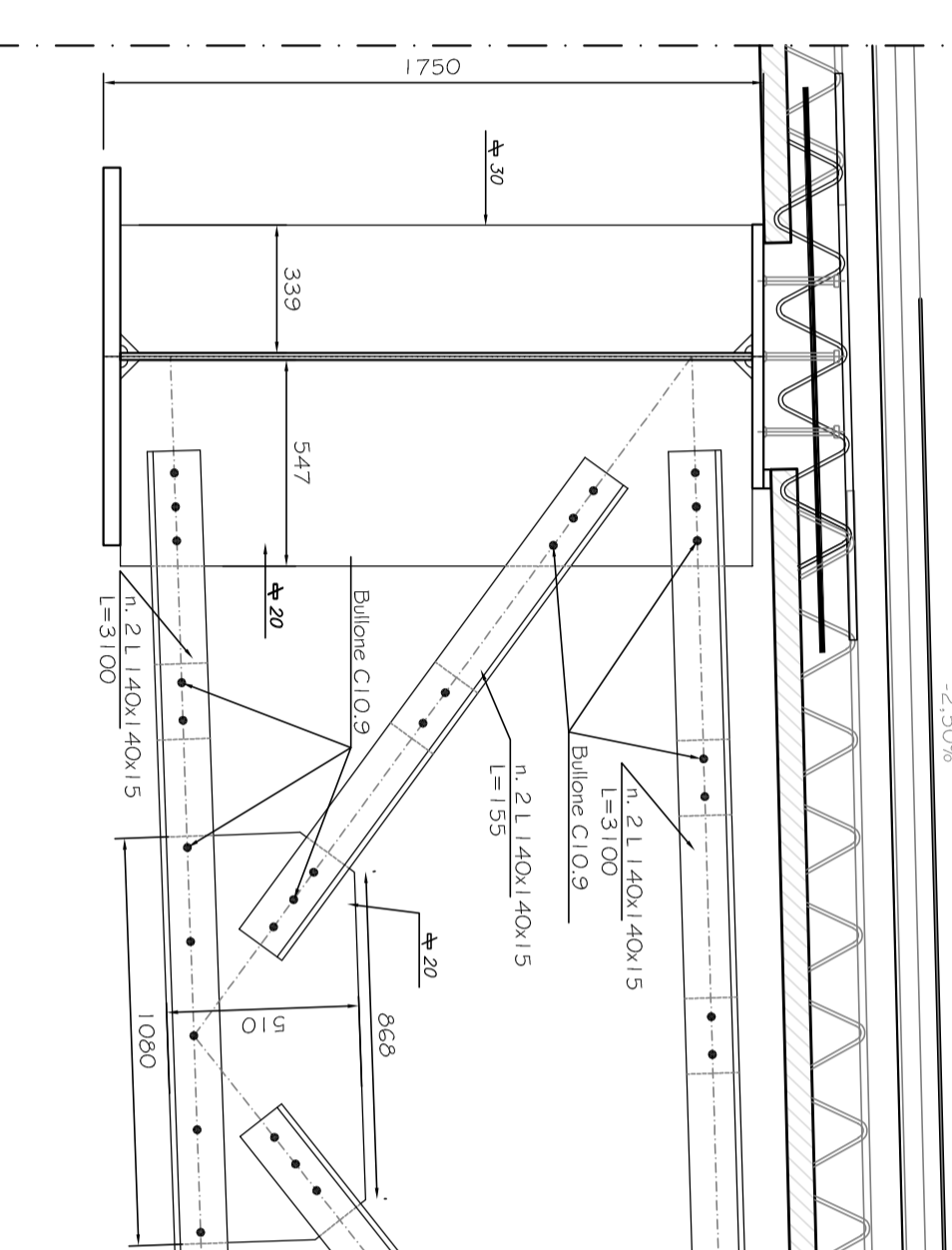

DETTAGLIO 'D'

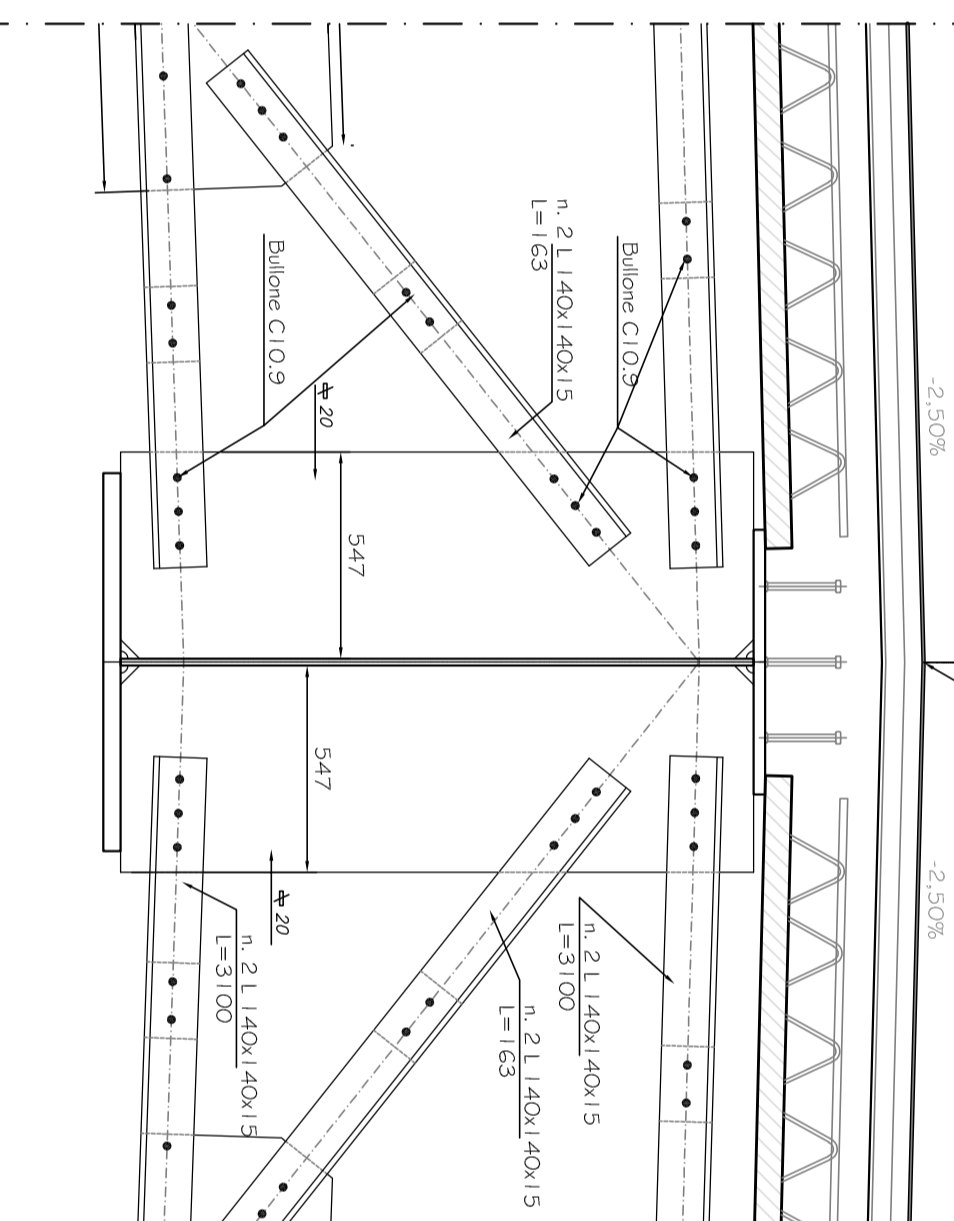

ANCORRAGGIO CONTROVENTI IN CAMPATA

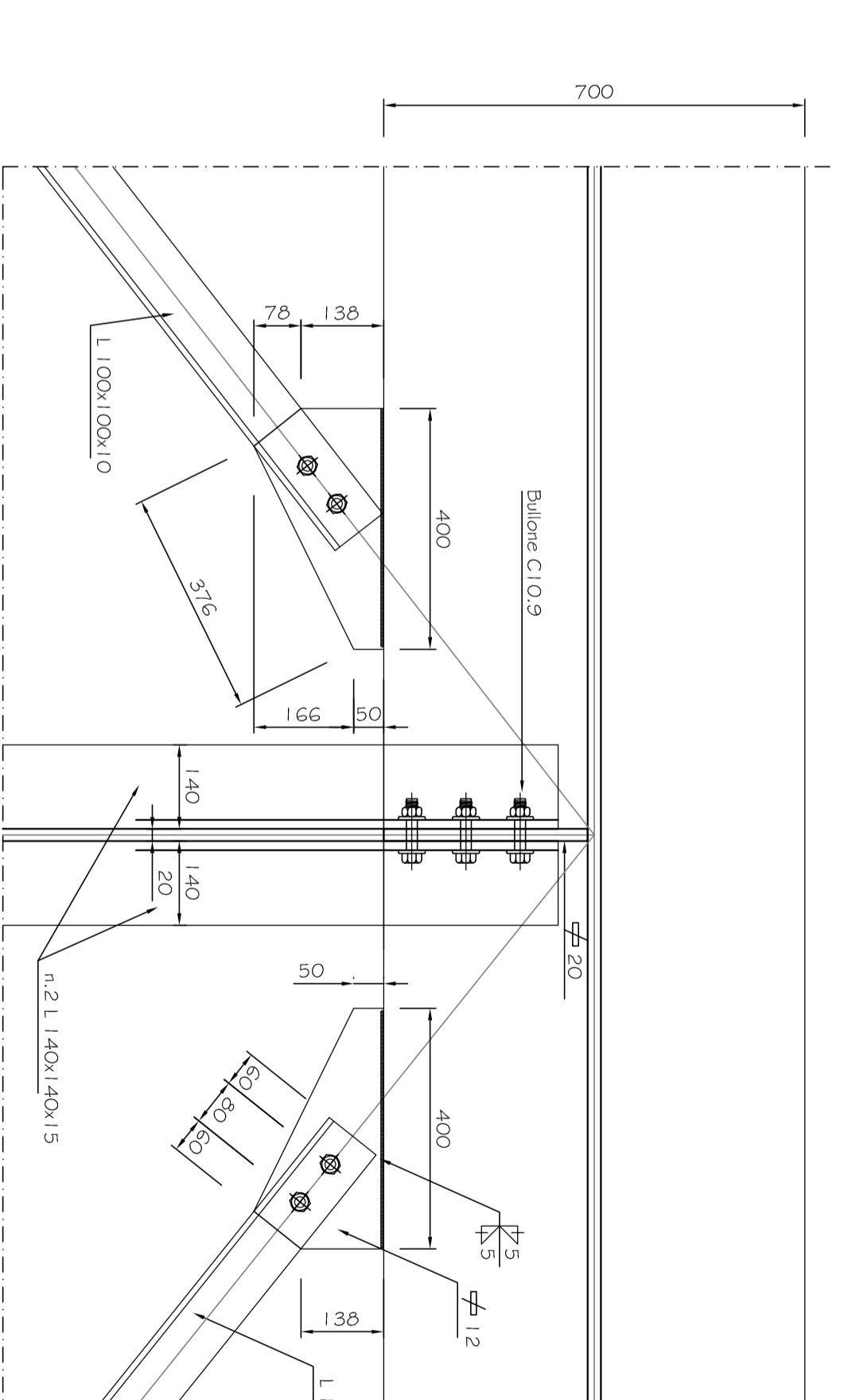

SEZIONE IN ASSE PIA 6

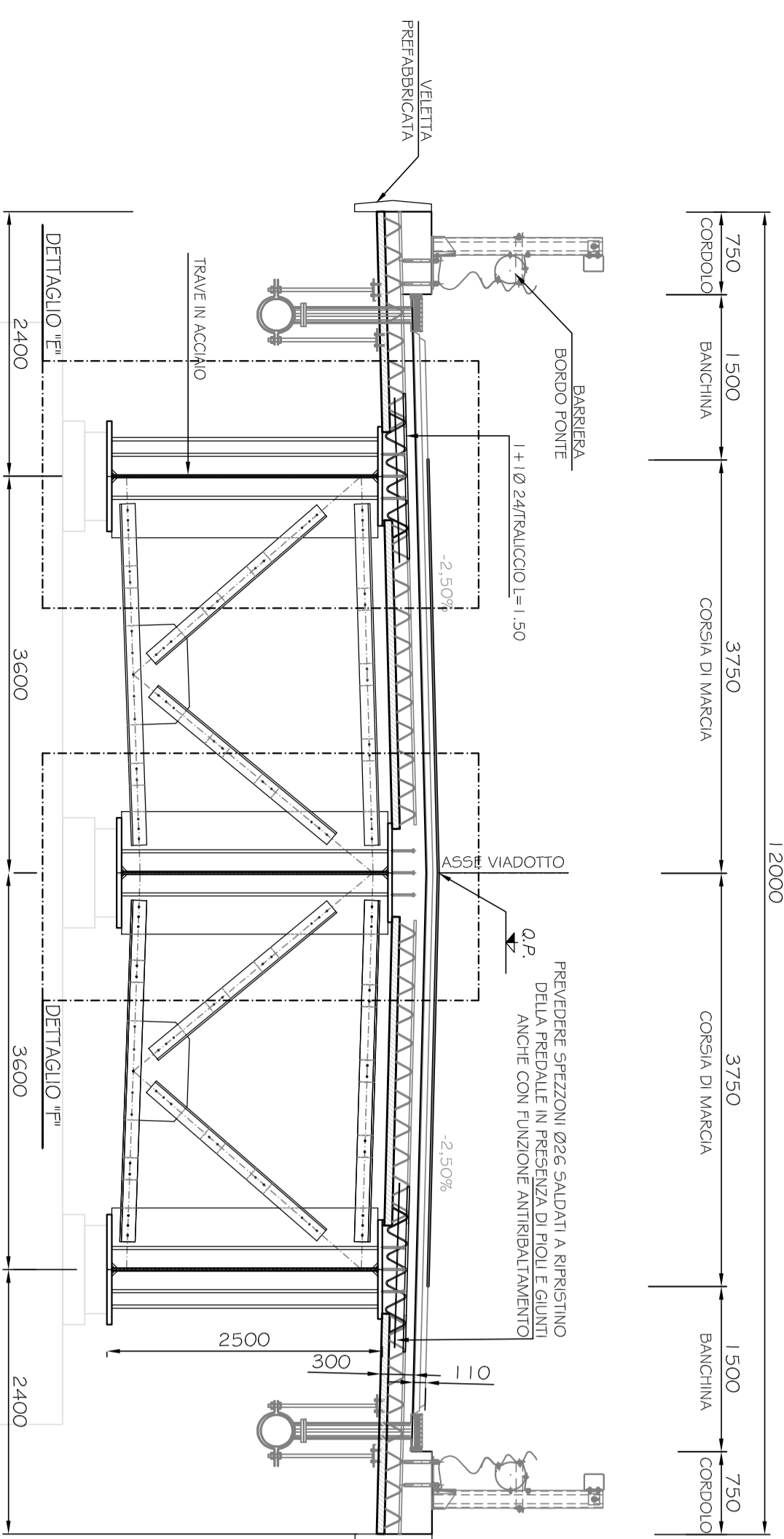

DETTAGLIO 'E'

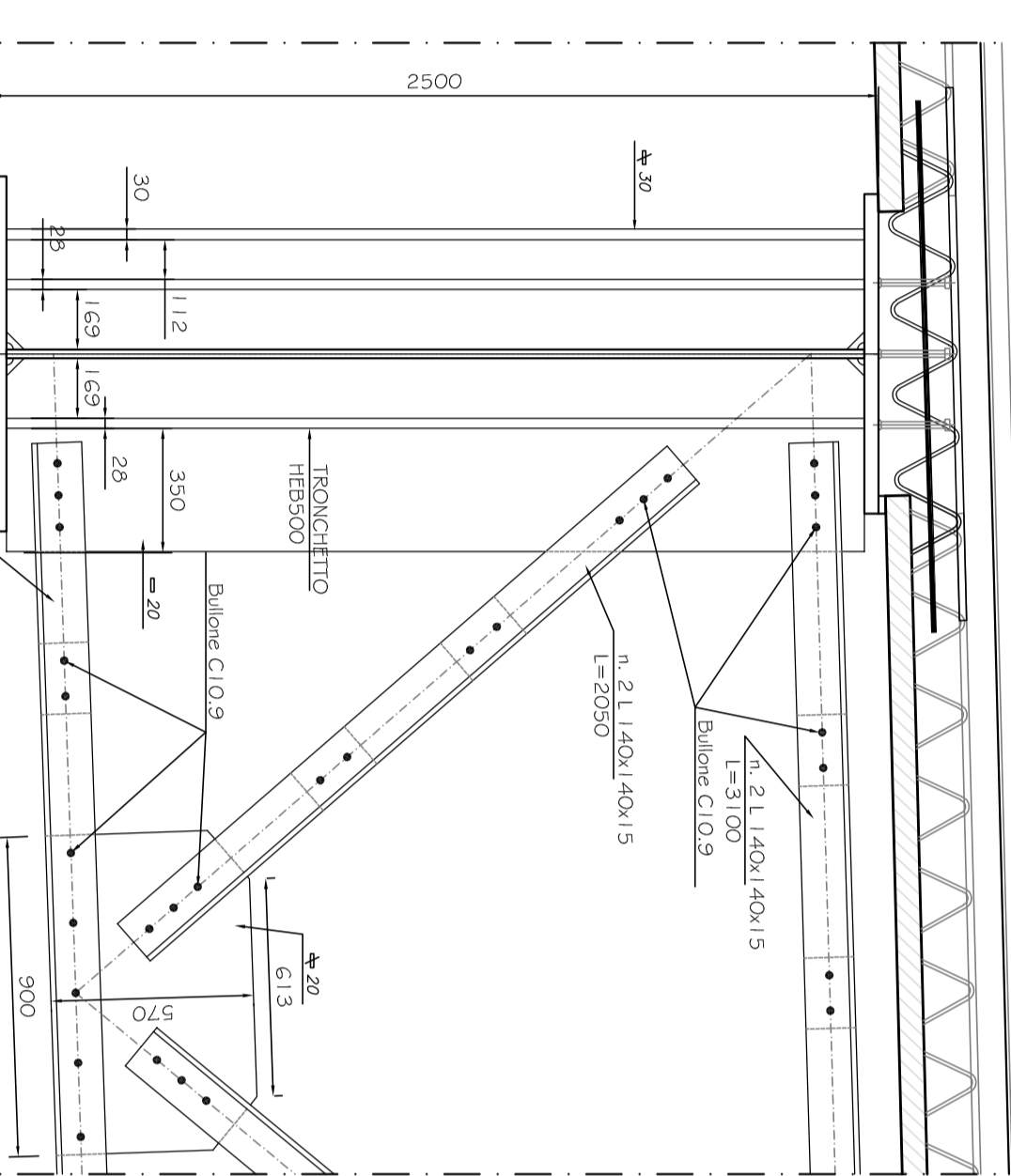

DETTAGLIO 'F'

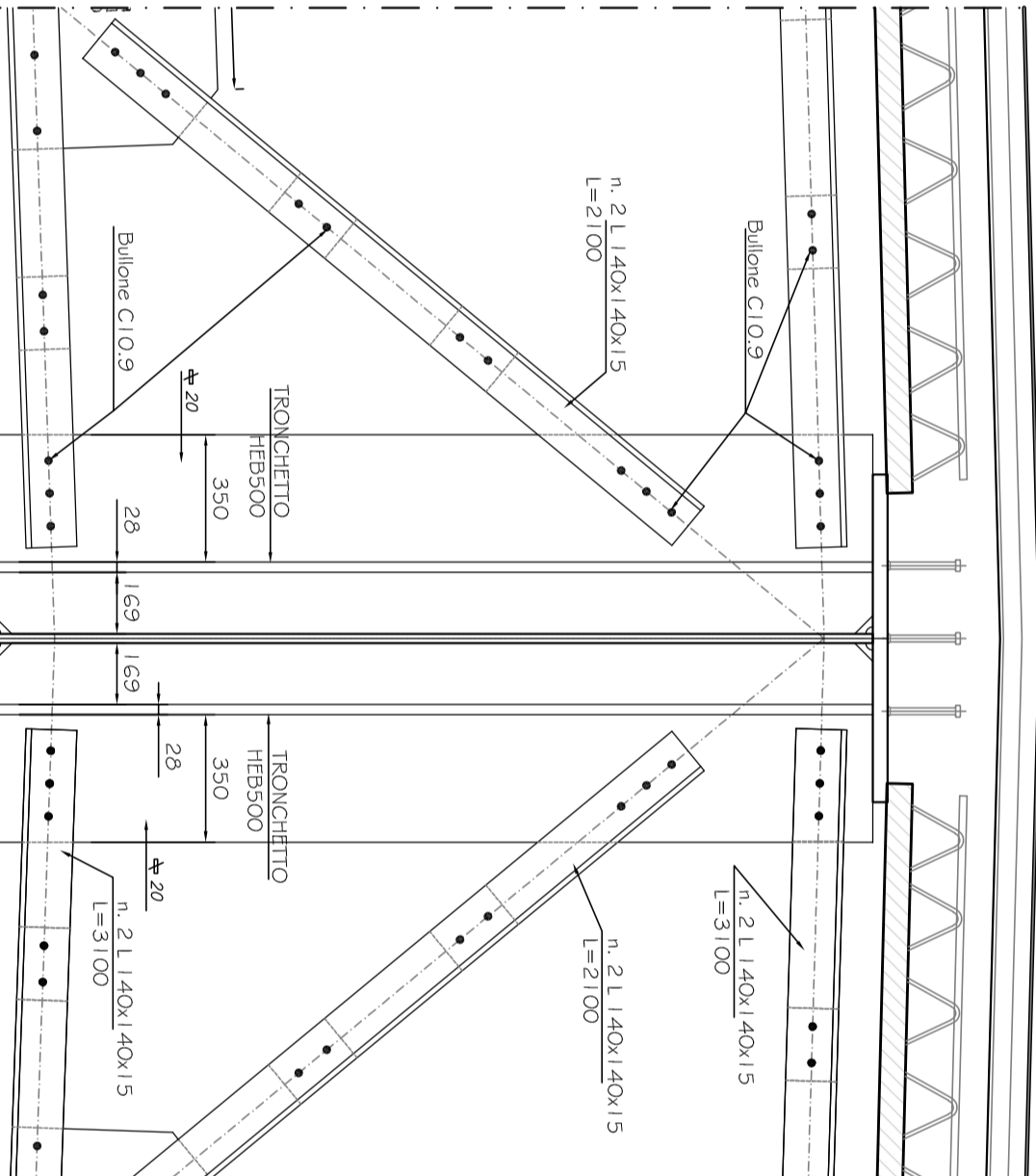

PREDALLA PREFABBRICATA

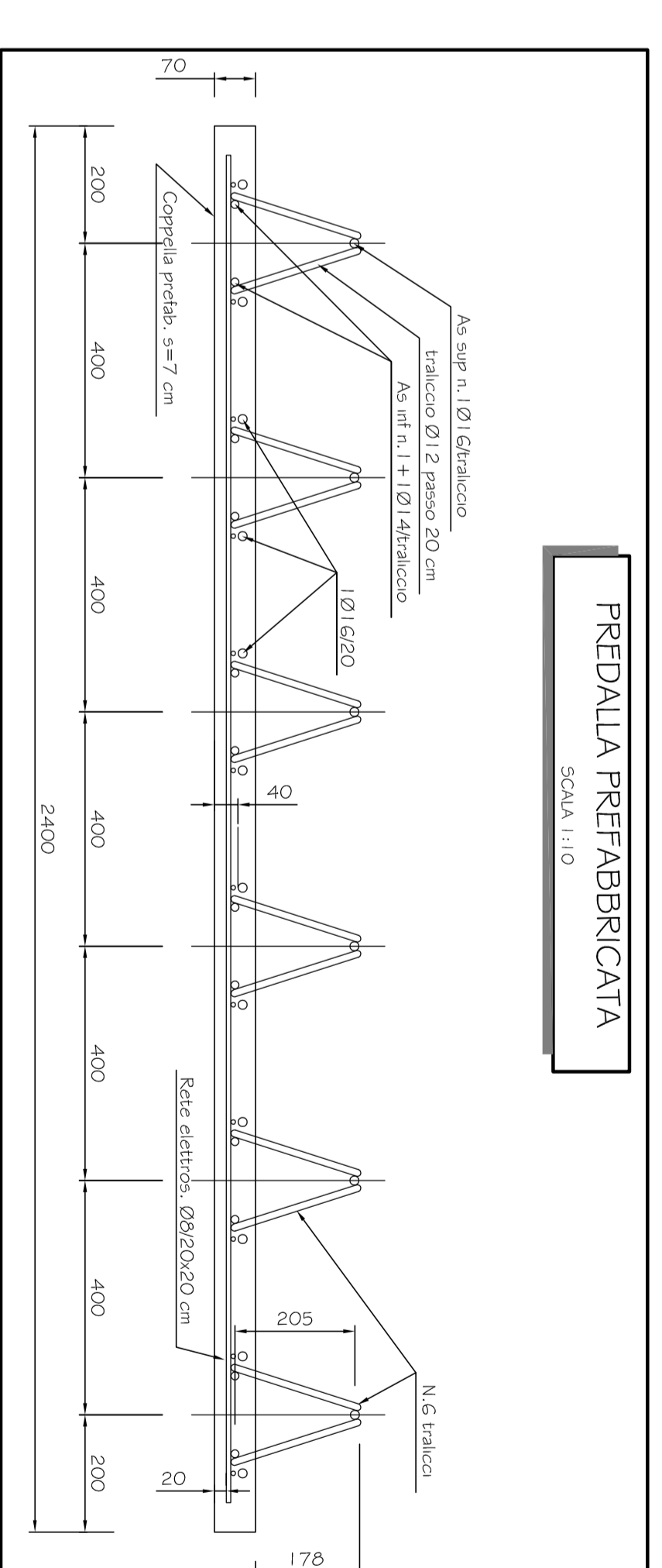

SEZIONE CORRENTE TRAVE H=2,50m

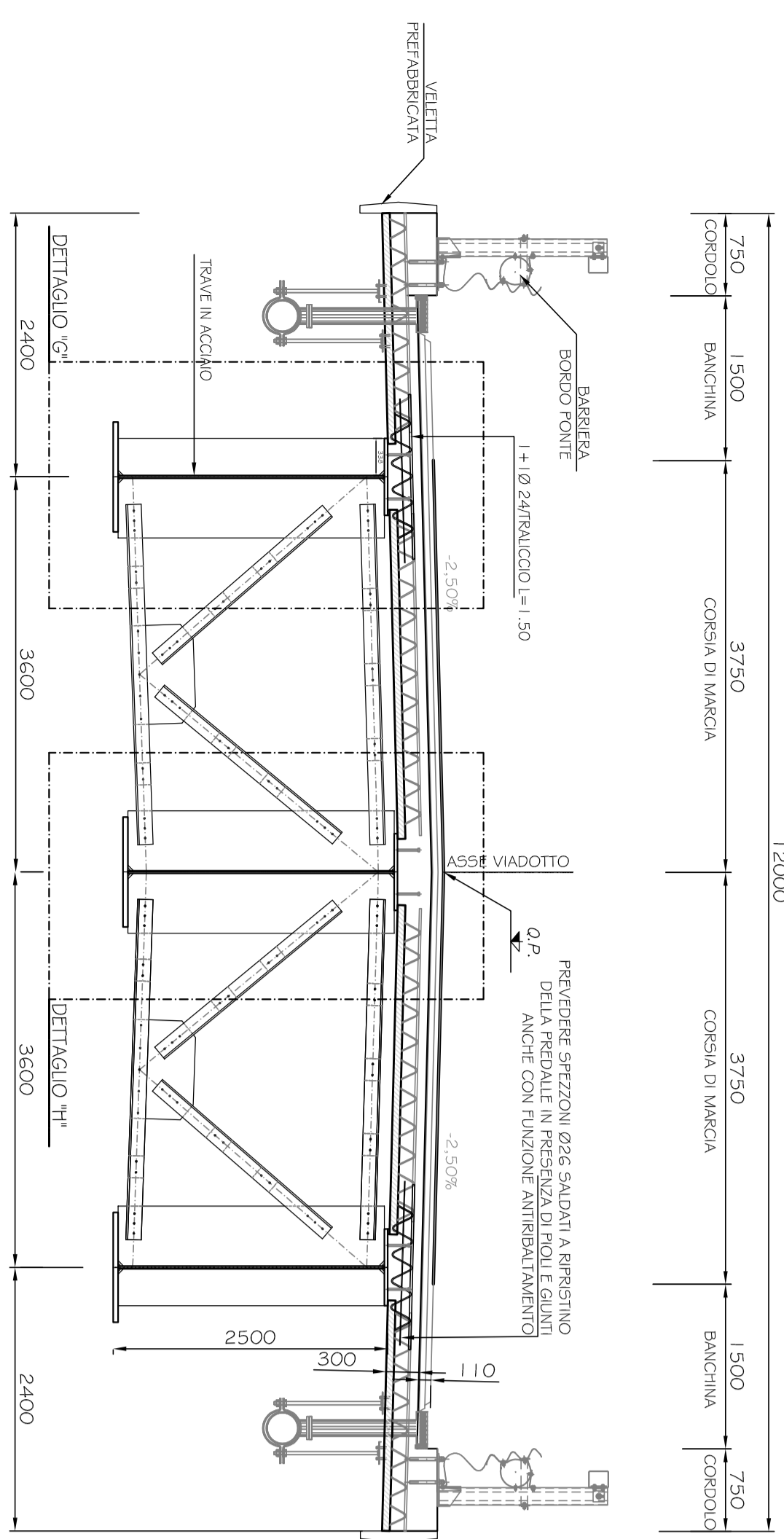

DETTAGLIO 'G'

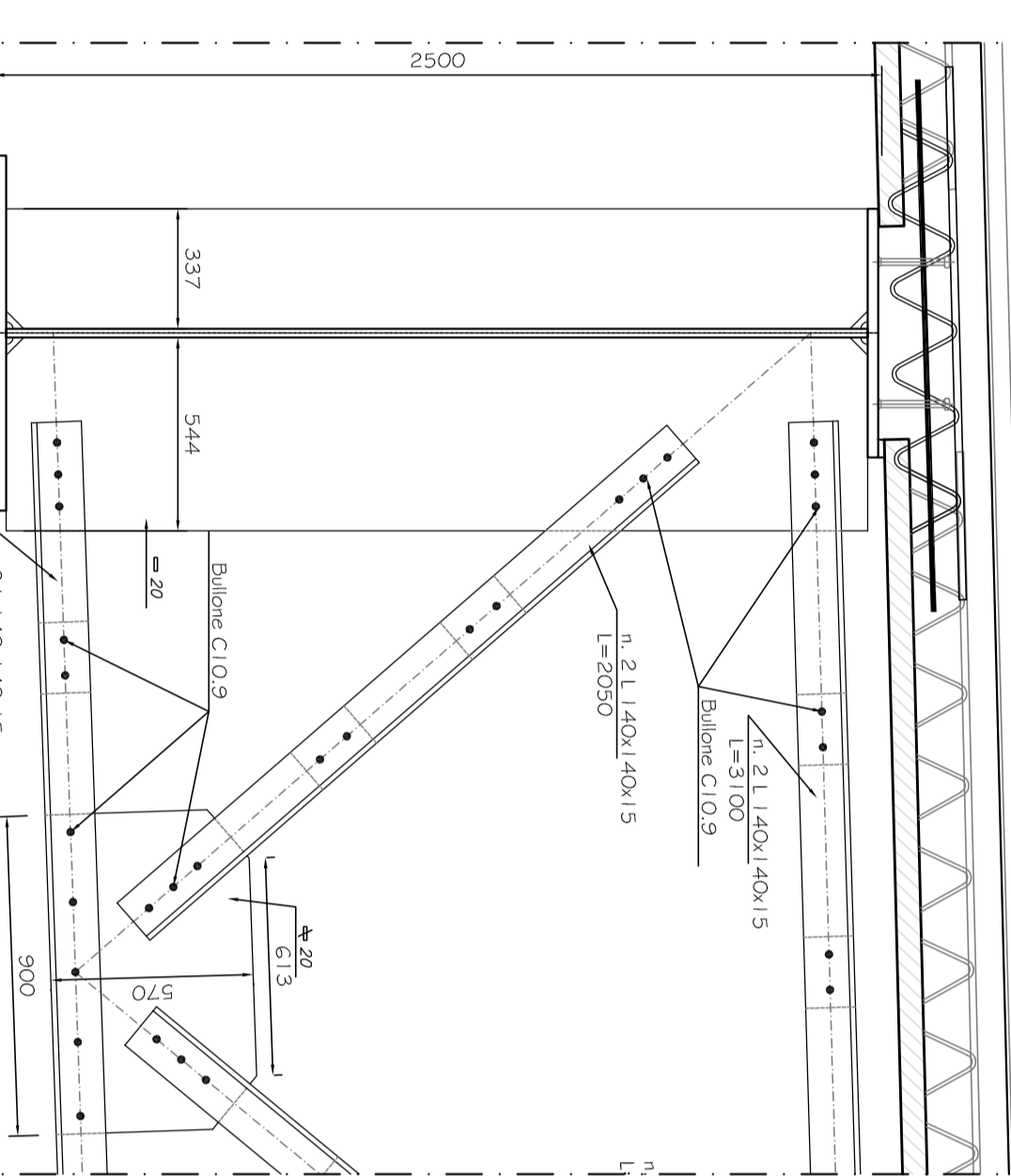

DETTAGLIO 'H'

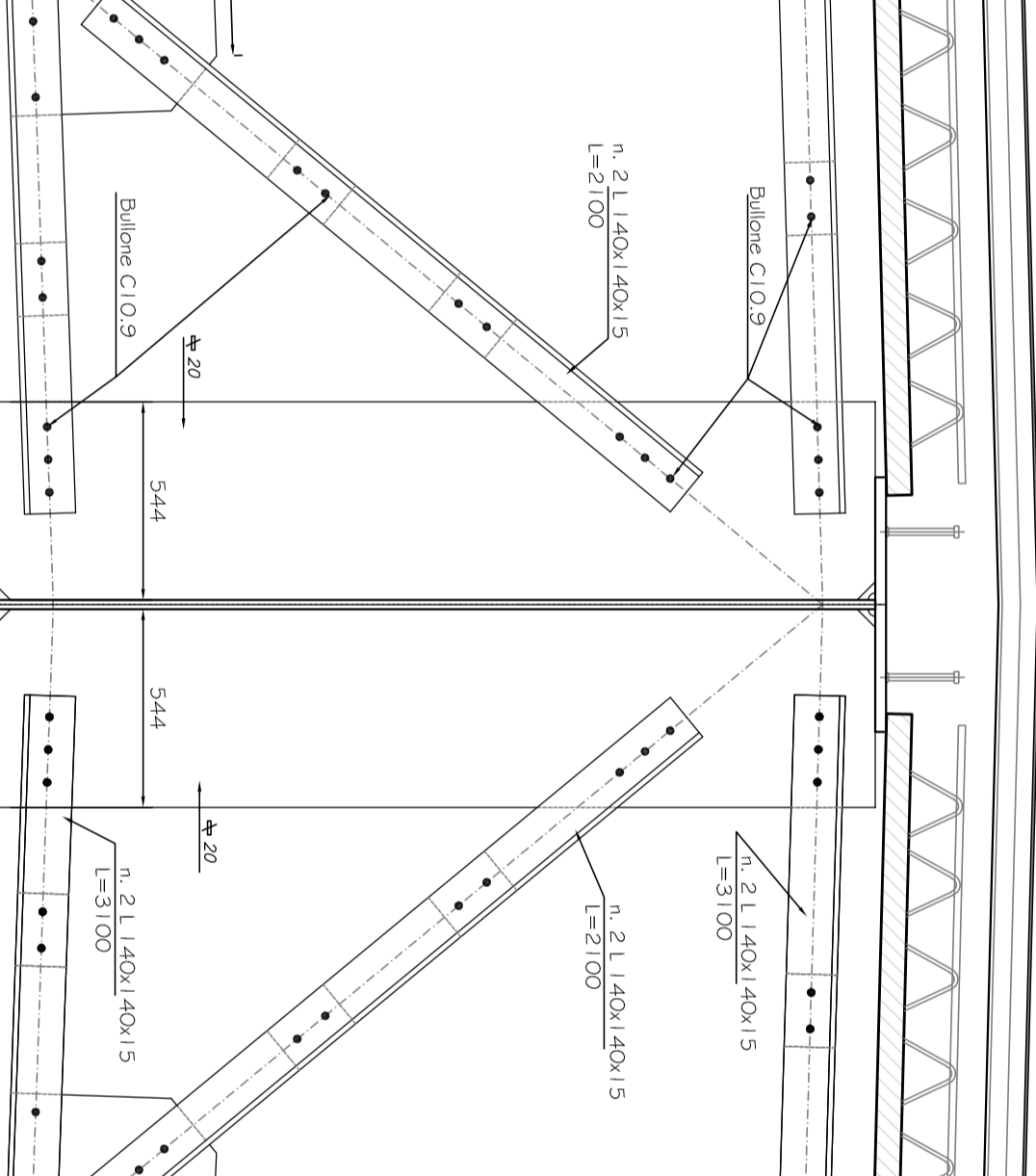

PREDALLE PREFABBRICATA

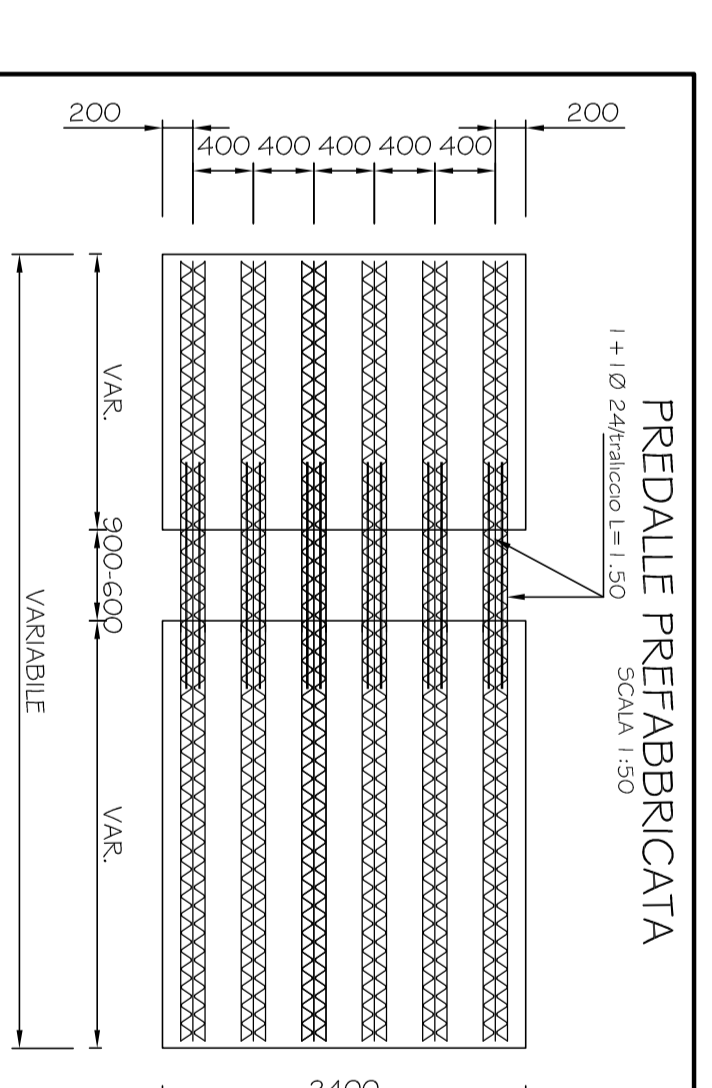

anas
Direzione Progettazione e Realizzazione Lavori

SISTEMA TANGENZIALE DI LUCCA
Viabilità Est di Lucca comprendente i collegamenti tra Ponte a Morone ed i caselli dell'autostrada A11 del Frizzone e di Lucca Est - 1° Stralcio

PROGETTO DEFINITIVO

PROGETTAZIONE: ANAS - DIREZIONE PROGETTAZIONE E REALIZZAZIONE LAVORI
PROGETTISTI: TOONIVI | 03 | STRICAO15
VERIFICATORI: TOONIVI | 03 | STRICAO15

OPERE D'ARTE MAGGIORI
V103 - VIADOTTO SU OZZORETTO
SEZIONI CORRENTE/TRAVERSA METALLICA E DETTAGLI

REV.	COMENTARI	SETT./2018	DATA	REDAZIONE	VERIFICAZIONE	APPROVAZIONE
A						
B						
C						
D						

PROGETTO
 VERIFICA
 APPROVAZIONE
 RENDICONTO